

The Station and Market Street Lawn Event Precinct

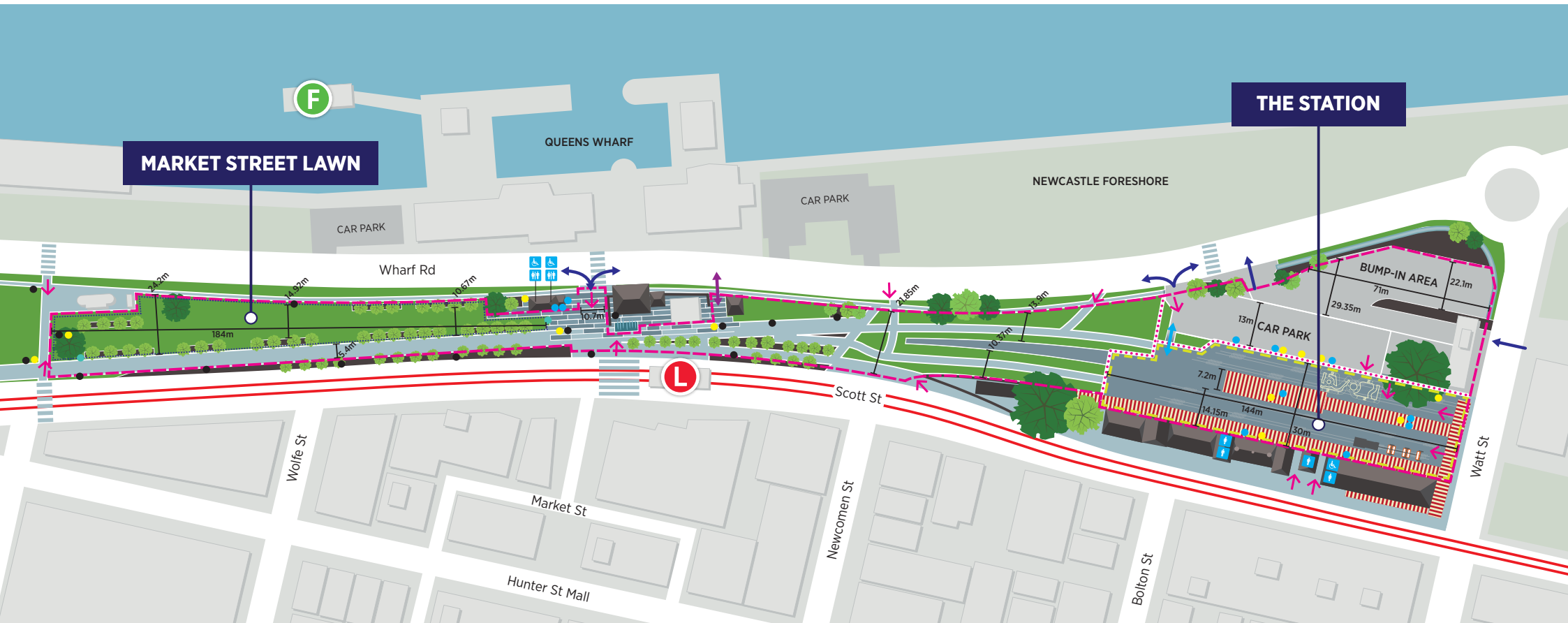

Hunter & Central Coast Development Corporation



Legend

- - - Area 1: Total site area = 20,550m²
- - - - Area 2: Grass area
Total green space = 3,000m²
= 3,000pax
- - - Area 3: Station Platform
Total platform area = 4,300m²
= 4,500pax

- - - - Internal fencing
- ➔ Pedestrian access
- ➔ Heavy vehicle access (under 6.5 tonnes)
- ➔ Heavy rigid vehicle (HRV) access
- ➔ Light vehicle access (under 4.5 tonnes)

- Toilets
- 15A 240V connections (1 outlet per smart pole)
- 3 phase power x4
- Water outlet
- Drinking fountain

- Water feature
- Undercover area
- Queens Wharf light rail stop
- Queens Wharf ferry stop

