

Notice of Footpath Closure

7th May 2021

Footpath Closure

Pedestrian access to the footpath adjacent to the Lee Wharf apartments will be restricted as shown on the image below. Please note the amended pedestrian route to the Honeysuckle Foreshore denoted in yellow, and bike path in blue. This footpath will be closed until the end of the project.

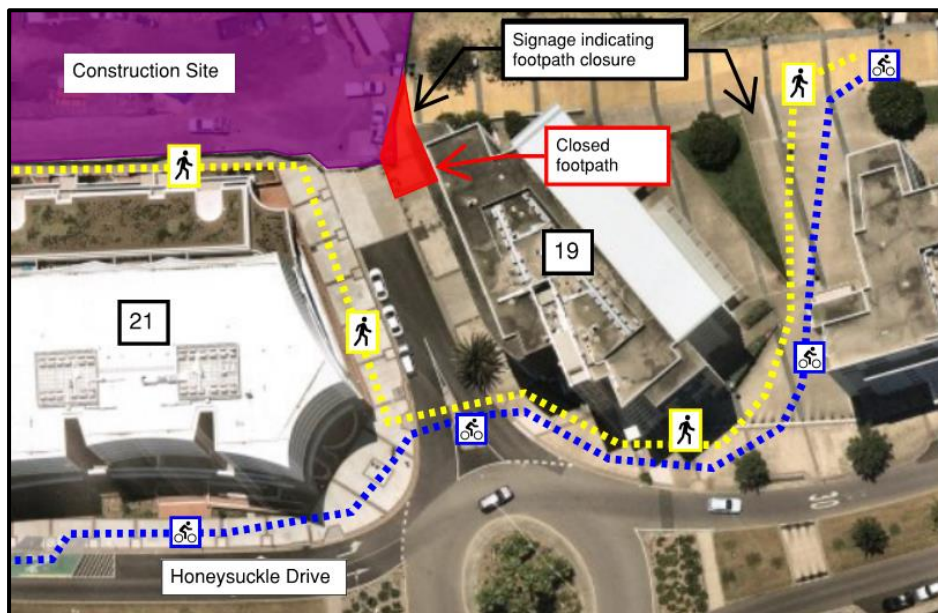

Signage shall be posted in the area until project completion.

Contact

For any enquiries or concerns regarding the Honeysuckle West Public Domain Project please contact Glascott Landscape and Civil.

Phone: 0499 737 666.

For more information about the project, please visit the Honeysuckle Works web page:
<https://www.hccdc.nsw.gov.au/honeysuckle-works>